

EPSM-ABEC 2009

ENGINEERING AND PHYSICAL SCIENCES IN MEDICINE & THE AUSTRALIAN BIOMEDICAL ENGINEERING COLLEGE CONFERENCE



EPSM -ABEC

Engineering and Physical Sciences in Medical &
The Australian Biomedical Engineering Conference 2009

8-12 November 2009
Hotel Realm, Canberra

SPONSORSHIP AND EXHIBITION PROSPECTUS

OVERVIEW

The EPSM-ABEC 2009 Conference will provide a high quality scientific program, informative workshops and an opportunity to share in knowledge and experience regarding engineering and physical science in medicine.

VENUE

Hotel Realm
18 National Circuit
Barton ACT 2600

DATES

Sunday 8 November – Thursday 12 November

Sunday 8 November 2009	Exhibition set up, Registration and Welcome reception
Monday 9 November 2009	Conference Sessions and Poster Session
Tuesday 10 November 2009	Conference Sessions
Wednesday 11 November 2009	Conference Sessions and Conference Dinner
Thursday 12 November 2009	Conference Sessions

BENEFITS FROM SPONSORING THE EPSM-ABEC 2009 Conference

The EPSM-ABEC conference offers sponsors the opportunity to gain increased exposure to an audience of biomedical engineers, clinical engineers and medical physicists and other physical scientists and technical specialists in medicine. Promotion of the conference offers exposure to your key audience through the website and conference communications before, during and after the conference. This is an ideal arena to launch new initiatives and products, and to showcase your company to existing and potential customers. The various packages listed in this document allow you to choose the most ideal mix to complement your company's existing marketing and sales strategies and demonstrate your support for the pharmaceutical science field.

EPSM-ABEC CONFERENCE 2009 EXECUTIVE COMMITTEE

- Michael Flood (Chairman)
- Brendan Hill
- Martin Van Lith
- Chin Voon
- Paul White
- Catriona McAuliffe
- Elizabeth Medley*
- Susanna Kable*

*CONFERENCE SECRETARIAT

Conference Logistics
PO Box 6150, Kingston ACT 2604
Tel: +61 2 6281 6624
Fax: +61 2 6285 1336
Email: conference@conlog.com.au



SPONSORSHIP OPPORTUNITIES AND ENTITLEMENTS

A range of sponsorship levels have been proposed to enable you to select a package that best suits the current marketing, budget and business objectives of your company. Should you wish to tailor a package to meet your marketing objectives, please call Susanna Kable at Conference Logistics on 02 6281 6624

SPONSORSHIP PACKAGES

The following opportunities are offered for your consideration. We welcome the opportunity to discuss these, or any other options you may consider relevant to your company. Please contact Susanna Kable with any sponsorship queries on 02 6281 6624 or email susanna@conlog.com.au. All bookings and subsequent arrangements will be made with the Conference Secretariat.

All prices quoted are **inclusive** of 10% Goods and Services Tax (GST)

PLATINUM SPONSOR (one only)

\$22,000

- Two complimentary registrations to the Conference including entrance to sessions, social tickets and a conference satchel
- Unlimited access to Early Bird registration for your organization
- Two additional tickets to the Welcome reception and Conference Dinner
- Option to have a 1-2 minute visual presentation display in the main session room prior to the start of the session each day
- Opportunity to give a brief welcome at the official Conference Opening
- Complimentary double exhibition booth (6m x 2m)
- Conference Delegates Listing, in accordance with the *Privacy Legislation 2001*
- Prominent positioning of your company logo and reference to your sponsorship in all promotional material produced after your subscription
- Your company logo and website link placed on the Conference website
- Verbal acknowledgement at the commencement of each day of the conference
- Option to insert two full page, colour advertisements into the conference handbook (artwork to be supplied press ready)
- Option to insert two pieces of literature into the conference satchel
- Prominent positioning of your company logo placed on the conference sponsor banner
- On screen recognition of your sponsorship in the main plenary room

GOLD SPONSOR

\$15,400

- One complimentary registration to the Conference including entrance to sessions, social tickets and a Conference satchel
- One additional ticket to the Welcome Reception and Conference Dinner
- Complimentary single exhibition booth (3m x 2m)
- Conference Delegates Listing, in accordance with the *Privacy Legislation 2001*
- Placement of your logo onto Conference promotional material produced after your subscription
- Your company logo and website link placed on the conference website
- Option to insert one full page advertisement into the conference handbook (artwork to be supplied press ready, colour finish by negotiation)
- Option to insert one piece of literature into the Conference satchel
- Your company logo placed on the Conference Sponsor's Banner
- On screen recognition of your sponsorship in the main plenary room

SILVER SPONSOR**\$8,800**

- One complimentary registration to the Conference including entrance to sessions, social tickets and a conference satchel
- One additional ticket to the Welcome Reception or Conference Dinner
- The option to reserve one trade exhibition booth at half price
- Conference Delegates Listing, in accordance with the *Privacy Legislation 2001*
- Placement of your logo onto Conference promotional material produced after your subscription
- Your company logo and website link placed on the Conference website
- The option to provide one piece of literature (up to A4 size) to be inserted into conference satchel
- Recognition of your contribution in the Conference Handbook
- Your company logo placed on the Conference Sponsors' Banner
- On screen recognition of your sponsorship in the main plenary room

BRONZE SPONSOR**\$3,850**

- The option to provide one piece of literature (up to A4 size) to be inserted into conference satchel
- Recognition of your contribution in the Conference Handbook
- Your company logo on the Conference website
- Your company logo placed on the Conference Sponsors' Banner
- On screen recognition of your sponsorship in the main plenary room
-

CONFERENCE DINNER SPONSOR**\$6,600**

- Company logo placed alongside the reference to the Conference Dinner in the Social section of the Conference Program
- Verbal acknowledgement by the Convenor at the beginning of the evening
- Four complimentary Conference Dinner tickets
- Opportunity to place Committee approved banners at the Dinner venue
- The option to provide one piece of literature (up to A4 size) to be inserted into conference satchel

WELCOME RECEPTION SPONSOR**\$4,400**

- Company logo along side the reference to the Welcome reception in the social section of the Conference Program
- Verbal acknowledgement by the Convenor at the beginning of the evening
- Four complimentary Welcome tickets
- Opportunity to place Committee approved banners in the Welcome Reception Venue
- The option to provide one piece of literature (up to A4 size) to be inserted into conference satchel

BREAKFAST SPONSOR**\$3,300 plus catering costs**

The opportunity to host a Breakfast session, in which your company will have

- Naming rights to the breakfast session
- Short presentation at the commencement of the breakfast
- Your company logo and website link placed on the Conference website
- The option to provide one piece of literature (up to A4 size) to be inserted into conference satchel

INTERNET HUB SPONSOR **\$4,400**

- Your company will have naming rights to the Conference Internet Hub. Which will be promoted to Conference delegates and exhibitors throughout the Conference and all promotional material
- Recognition of your contribution in the Conference Handbook
- Your company logo placed on the Conference Website
- The option to provide one piece of literature (up to A4 size) to be inserted into conference satchel

CAPPUCCINO STALL SPONSOR **\$6,600**

- Corporate Branding of the Cappuccino stall (corporate colours and logo)
- Includes cappuccino machine operator, coffee and cappuccino machine
- Company acknowledgment as a sponsor in the Registration Brochure and the Conference Handbook
- Display area within the Cappuccino Stall (3m x 2m)
- The option to provide one piece of literature (up to A4 size) to be inserted into conference satchel

POSTER DISPLAY WINE AND CHEESE TASTING SPONSOR **\$3,300**

- Company logo placed alongside the mention of the Poster Session in the Social section of the Conference Program
- Verbal acknowledgement of your contribution at the commencement and conclusion of the Poster Display wine and Cheese Tasting evening
- Opportunity to place committee approved banners in the poster session venue
- The option to provide one piece of literature (up to A4 size) to be inserted into conference satchel

KEYNOTE SPEAKER SPONSORSHIP **\$8,800 (International Speaker)**
\$5,500 (National Speaker)

- Consultation in the choice of speaker
- Naming rights to the Keynote Speaker's presentation(s) i.e. the speaker will be billed as the "your organisation "visiting speaker"
- Your company logo displayed on the screen in the session venue prior to the keynote speaker's presentation(s)
- Acknowledgement by the session chairperson to the keynote speakers presentation(s)
- Acknowledgement and company logo in the Conference handbook
- The opportunity to place promotional signage (committee approval) in the venue for the duration of the Keynote speakers presentation(s)
- The option to provide one piece of literature (up to A4 size) to be inserted into conference satchel
- Sponsors should note that it is the policy of this conference to fly speakers at best price economy airfares and to provide accommodation in a standard room at the conference hotel

SESSION SPONSORS **\$3,300**

- Your company logo/name will be used in all electronic signage for the Session Room for the duration of the Conference
- Your company name will be used to describe that session in the Conference Handbook and final program i.e. The "your company name" session

NAME BADGE SPONSORSHIP **\$1,100**

- Your company logo/name will be placed on all Conference badges along with the Conference logo and worn by all delegates for the duration of the conference

PROGRAM ADVERTISEMENT

\$2,750 (back cover page)

\$1,980 (front cover page)

\$990 full page

\$660 half page

\$440 ¼ page

- The option to insert either a full page, half page or quarter page advertisement into the Conference Program (All artwork to be provided press ready by the sponsor)

SACHEL SPONSOR

\$5,500

- Logo included on Conference Satchel
- One complimentary full registration
- Acknowledgment of sponsor in the Program Handbook
- Sponsor's logo included on the website
- The option to provide one piece of literature (up to A4 size) to be inserted into conference satchel

SACHEL INSERT

\$1,100

- The option to provide one piece of literature (up to A4 size) to be inserted into conference satchel. Sponsor to provide sufficient units to go into delegate bags The Conference Secretariat will confirm final numbers but expect to provide up to 350 units

NOTE PADS

\$550

- Notepads for delegate use during and after the Conference Sponsors to provide the notepads at their own expense, A4 or A5 size subject to approval of the artwork by the conference committee and will be included in the conference satchel The Conference Secretariat will confirm final numbers but expect to provide up to 350 units

PENS

\$550

- Pens for delegate use during and after the Conference Sponsors to provide the pens at their own expense, subject to approval of the artwork by the conference committee and will be included in the Conference satchel The Conference Secretariat will confirm final numbers but expect to provide up to 350 units

EXHIBITION OPPORTUNITIES

EXHIBITION BOOTH / SPACE

\$3,300

- One exhibition booth (3m x 2m) for the duration of the Conference including:
 - exhibition booth in Velcro-compatible material
 - one table and chair will be provided
 - fascia board with company name
 - 2 x spotlights affixed to fascia board
 - 1 x double outlet power point with a 4 amp capacity
- One complimentary Exhibitor Staff Registration, including, morning tea, lunch and afternoon tea daily Does **not** include ticket to the Welcome Reception or the Conference Dinner
- Copy of the final program

Additional Representatives

An additional representative can also attend the Trade exhibition area and Conference at a cost of \$330 per day This includes morning tea, lunch and afternoon tea This does not include tickets to social functions This fee will apply to all additional representatives with no exception.

DATES & TIMES

Bump in time: Sunday 8th November 2009

The trade display will be built in on Sunday morning

Exhibitors will set up between 2pm and 5pm on Sunday 8th November

The exhibition will be open to delegates as follows:

Monday 9th November 2009

Tuesday 10th November 2009

Wednesday 11th November 2009

Thursday 12th November 2009 (closes at lunchtime)

EXHIBITION FLOOR PLAN

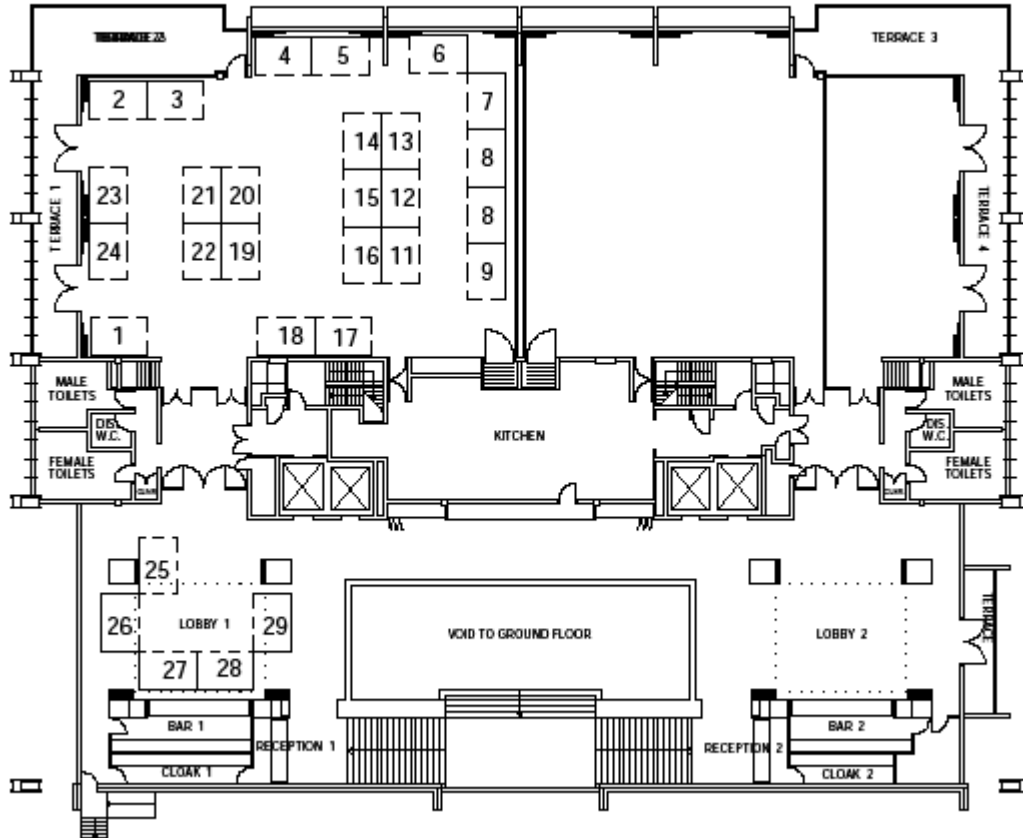

1st Floor
Hotel Realm, National Circuit, Barton

ADDITIONAL INFORMATION

HIRE OF FURNITURE

A catalogue featuring an extensive furniture range from the exhibition design company is available on line at www.sbx.biz The exhibition hire company, SBX will invoice you directly for any additional furniture of display items

DISPLAY DESIGN

All display materials must be flameproof No attachment or defacement is to be made to the flooring, ceilings, internal or external walls of the exhibition display area or the furnishings of the Hotel Realm

Each exhibitor must keep their display within the dimensions of the exhibition booth Should you wish to provide your own booth design or prefabricated booth module in your allocated area, you must submit your design plans to the Conference Secretariat for approval by the Committee and venue

LIGHTING AND POWER

Any electrical installations outside of what will be supplied in your booth package must be submitted to the exhibition hire company Should you require additional power supplies (ie more than 4 amps of power) a charge will be calculated to cover costs and will be billed to you

TERMS & CONDITIONS

1: LIABILITY & INSURANCE

Subject to clause 2, the exhibitor and the servants agents and contractors of the exhibitor occupy and use the exhibition space/booth allotted under this exhibition contract and enter the Hotel Realm and act under or pursuant to this exhibition contract at their own risk

The exhibitor hereby indemnifies and releases Conference Logistics and EPSM-ABEC ("the Committee"), the Hotel Realm ("the Venue Managers") and all and each of the sponsors of the exhibition ("the Sponsors") against all actions, suits, costs, claims and demands brought against the Committee, the Venue Managers and the Sponsors or any of them by any person firm or corporation for any damage or loss caused directly or indirectly to or suffered by any person firm or corporation as a result of any act or default of the exhibitor or the servants, agents, contractors or invitees of the exhibitor or resulting directly or indirectly from the attendance of the exhibitor at either the exhibition or any Demonstration Activities or both including travel to and from such venues and without limiting the foregoing the Committee, the Venue Managers and the Sponsors or any of them shall not in any circumstances be liable for any loss damage or injury which may occur to the exhibitor or the servants, agents or contractors of the exhibitor or for any damage to their property including damage to exhibits, plant, equipment, fixtures, fittings or other property whatsoever or for any loss of profits which they may suffer howsoever caused

It is strongly advised that each exhibitor seek to cover their equipment, exhibits and display material with adequate insurance and also effect public risk insurance at the expense of the exhibitor

2: IMPLIED WARRANTIES

In the event any statute implies any term condition or warranty into this agreement which cannot be lawfully excluded, such terms will apply to this agreement, save that the liability of the Committee and each of them for breach of any such implied term will be limited, at the option of the Committee, to any one or more of the following:

- the replacement of goods to which the breach relates or the supply of equivalent goods;
- the repair of such goods;
- the payment of the cost of replacing the goods or of acquiring equivalent goods; or
- the payment of the cost of having the goods repaired

3: CONSEQUENTIAL DAMAGE

The Committee will not be liable for any indirect or consequential damages arising out of a breach of this exhibition contract

4: SECURITY

The Venue will be closed and locked out of the exhibition hours. The Committee and the Venue Managers and their officers and employees, separately or collectively are not responsible for any damage to or for the loss or destruction of an exhibit, from fire or theft or accidents or injury resulting from such causes. Security staff dedicated to duty in your booth area can be engaged at the exhibitor's cost.

5: VARIATIONS

The Committee may in the event of any circumstance which render it necessary, vary the booth or stand space allocation and the exhibitor will accept such re-allocation without any claim for a reduction in charges or otherwise

6: UNAVOIDABLE OCCURRENCES

In the event that the exhibition is cancelled or delayed through no fault of the Committee, the Venue Manager or the Sponsors including but not limited to fire, flood, labour disputes, natural disasters, acts of God, civil disorders, riots, insurrections, work stoppages, slow downs or disputes, or other similar events then the exhibitor shall not be entitled to any refund or to claim for any loss of damage.

7: ASSIGNMENTS & SUBLETTING

No exhibitor shall assign, sublet or share the whole or any part of the space booth allotted without the knowledge and consent of the Committee.

8: HOURS

The Committee shall determine the hours during which the exhibition shall be conducted and as to hours of access for exhibitors including variations of such times as shall be necessary.

HOW TO BOOK

SPONSORSHIP

To confirm your sponsorship, we require a completed application to sponsor form, together with a **50% payment upon application** Sponsorship opportunities will be allocated in order of confirmation of application and payment of the deposit Balance due 30 June 2009.

EXHIBITION BOOTH/SPACE

Early booking is essential as space is at a premium To confirm your space we require a completed application to exhibit form, together with a 50% deposit on application Balance due 30 June 2009.

APPLICATION FORMS

Application form contained within this proposal

PAYMENT DETAILS

Cheques should be made payable in Australian Dollars to:

Please forward your application and payment to:
EPSM-ABEC 2009 Conference
c/- Conference Logistics*
PO Box 6150
KINGSTON ACT 2604

CANCELLATION POLICY

In the event of cancellation of either sponsorship or exhibition booths, the Committee reserve the right to retain monies paid in full unless resold. In the case of the cancellation of booth(s), please note that unless we are able to resell the booth, there will be no refund of monies paid. If the balance payment on the booth(s) is not received by the due date, the allocated booth(s) will be cancelled

CONTACT DETAILS

If you require further information on any of the exhibition or sponsorship opportunities contained within this document, please contact:

EPSM-ABEC 2009

Conference Logistics*
PO Box 6150, Kingston ACT 2604
Tel: +61 2 6281 6624
Fax: +61 2 6285 1336
Email: conference@conlog.com.au

**acting as agent for EPSM-ABEC*

APPLICATION TO SPONSOR/EXHIBIT
EPSM-ABEC 2009 Conference
Hotel Realm November 2009

SPONSOR/TRADE EXHIBITOR INFORMATION please print clearly

Title:..... Given Name:..... Surname:.....
 Organisation:.....
 Postal Address:.....
 Suburb:..... State:..... Postcode:.....
 Tel: (.....)..... Fax(.....)..... Mobile:.....
 Email:.....

SPONSORSHIP PACKAGES

We wish to promote our organization by purchasing the following package's (please tick one)

- Platinum Sponsor \$22,000
- Gold Sponsor \$15,400
- Silver Sponsor \$8,800
- Bronze Sponsor \$3,850
- Conference Dinner Sponsor \$6,600
- Welcome Reception Sponsor \$4,400
- Keynote Speaker Sponsor International \$8,800
- Internet Café Sponsor \$4,400
- Cappuccino Stall Sponsor \$6,600
- Satchel Sponsor \$5,500
- Breakfast Sponsor \$3,300
- Session Sponsor \$3,300
- Poster Display (Wine and Cheese Tasting Sponsor) \$3,300
- Name Badge Sponsor \$1,100
- Program Advertisement (\$as per document)
- Satchel Insert \$1,100
- Note Pad Sponsor \$550
- Pen Sponsor \$550
- Keynote Speaker National \$5,500

TRADE EXHIBITION BOOKINGS (please list in order of preference):

- As a Platinum Sponsor, I wish to reserve a double exhibition spaces (6mx2m) at no charge, I would prefer booths# _____ or booths# _____
- As a Gold Sponsor, I wish to reserve one exhibition space (3mx2m) at no charge I would prefer booth# _____ or booth# _____
- As a Silver sponsor, I wish to reserve one exhibition space (3mx2m) at a 50% discount I would prefer booth#or booth# _____
- I wish to reserve exhibition booth (3mx2m) @ \$3,300
 - Space Only
 - Shell Scheme I would prefer booth # _____ or booth # _____
- I wish to book a place for..... additional representative/s at a cost of \$330 per person per day
 Names of representative/s are.....
- I wish to purchase.....dinner tickets at \$110 each
- I wish to purchase.....Welcome Reception tickets at \$45 each

PAYMENT SUMMARY

Sponsorship: Sponsorship package/s (minimum deposit 50% of total)	\$
Exhibition Booth booking/s (minimum deposit 50% of total)	\$
Additional Representative/s	\$
Additional Tickets	\$
TOTAL	\$

PAYMENT DETAILS

- I enclose cheque payable to EPSM-ABEC 2009
 - I am faxing my booking form and cheque will follow
 - I wish to pay by credit card and hereby authorise you to charge the amount of \$ _____ to my credit card
- Please Charge my Master Card Visa Amex Diners

Expiry Date:..... /.....

Card Holder Name:..... Card Holder Signature:.....

PAYMENT DEADLINES

50% deposit on application Balance due 30 June 2009